

# SUPER 213-32 Face Recognition Access Control Terminal with Digital Detection Module

## Product Overview

SUPER 213-32 digital detection face recognition access control terminal is a kind of access control device with precise recognition rate, large storage capacity and fast recognition, which integrates UNV face recognition technology and non-contact temperature detection technology. The digital detection module supports rapid body temperature detection. Thus, the product can achieve face recognition and temperature detection at the same time, and support warning people with abnormal body temperature. It can be widely applied in the crowded places, such as smart communities, schools, office buildings, hospitals and other important areas.



Wall-mounted



Floor-stand mount (need additional EP-S31-W-NB bracket)

## Product Features

Support non-contact detection, support warning people with abnormal body temperature

Support body temperature detection and personnel information binding, which can quickly confirm personnel information and do body temperature detection

Support configure temperature detection threshold value, and personnel access authority can be configured through temperature detection threshold value  
Non-contact temperature detection module, measurement range is between 30°C to 45°C, measurement accuracy can reach 0.1°C, measurement deviation is less than or equal to 0.3°C, and measurement distance is 1 meter

Deep learning algorithm model based on UNV independent intellectual property rights, face recognition accuracy rate > 99%, false rate < 1%

Built-in deep learning dedicated chip, supports local offline recognition, 10,000 face capacity, face whitelist (1: N)

- Fastest recognition time 0.2 seconds, various model merge mode are used to reduce false rate and increase pass rate
- WDR, 2MP (1080P) low illumination wide-angle camera and F1.6 large aperture lens for capturing high quality image with various complex lighting scenes
- Support anti-spoofing detection based on deep learning algorithm, effective against fraud such as photo and video
- Support face metering and human metering for fast adapting to ambient light
- Suggested height for face recognition: between 0.8m and 2.2m, face recognition distance: 0.2m to 2.9m
- Support screen sleep mode, keep the minimum brightness to prevent glare at night
- Support add up to 6 photos of the base library for a single person
- Support video capture, support ONVIF protocol
- Support face, card, password and QR code authentication to control door open
- Two-way audio with indoor monitor
- Built-in 4G EMMC front end storage, stable and reliable, up to 8,000 events capacity (with images)
- Support tamper protection, support door open timeout and time exceed alarm function to keep door opening during fire alarm active

## Ordering Information

| Model        | Comment   |
|--------------|---|
| SUPER 213-32 | Face recognition access control terminal with digital temperature measurement module, including face recognition access control terminal and digital detection module |

## Product Specification

| Features Parameter             | Description  |
|--------------------------------|--|
| Operation System               | Linux  |
| Face Recognition Accuracy Rate | >99%   |
| Face Recognition Time          | 200ms  |
| Face Capacity                  | 10,000   |
| Card Capacity                  | 100,000  |
| Storage Capacity               | 4GB  |
| Event Capacity                 | 8,000 (with images)  |
| Measurement Range              | 30℃ - 45℃  |
| Measurement Accuracy           | 0.1℃   |
| Measurement Deviation          | ≤0.3℃  |
| Measurement Distance           | 1m   |
| Authentication Mode            | Face Whitelist: (1: N)   |
|                                | Card:(1:N)   |
|                                | Face +Body temperature   |
|                                | Mask Detection   |
| Door Opening Method            | Face, Password, QR code, Card  |
| Communication Mode             | 10/100Mbps adaptive network port   |
| Card Type                      | Mifare 1 Card  |
| User Management                | Support user library addition, deletion, update  |
| Record Management              | Support local recording and real-time upload   |
| Interface                      | LAN×1, Wiegand Input×1, Wiegand Output×1, RS485×1, Alarm Input×2, Alarm Output×1, USB2.0×1, Lock×1, Door Contact ×1, Exit Button×1 |
| Power Supply                   | Input 12V±25% DC   |
| Screen                         | Touch Screen, Size:7 inch, Resolution: 600×1024  |
| Camera                         | Dual Lens, 2MP, 1080P  |
| Supplement Light               | LED soft light and infrared light  |
| Dimensions (L×W×H)             | For terminal : 134.0mm×33.0mm×305.0mm  |
| Working Environment            | For terminal: -20℃-65℃, Relative Humidly<95% (non-condensing)<br>For module: 15℃-30℃   |
| Protection Level               | Both terminal and module: IP 54  |
| Application Situation          | Indoor, No wind  |

## Product Dimensions

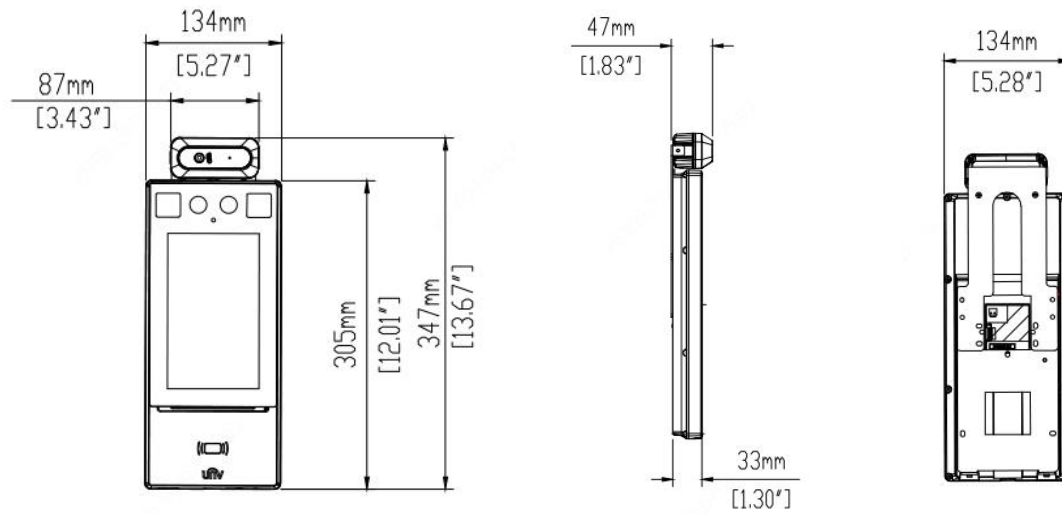

**Lilian**

**SHANGHAI SUPERHOUSE BUILDING MATERIAL CO.,LTD**

Tel: 86 21 5822 0630 Fax: 86 21 5822 0631

Mob: 86(0)13585723609 WECHAT: 13585723609

**SuperHouse** **16** YEARS more @ [www.isuperhouse.com](http://www.isuperhouse.com)  
for a super life

**PRODUCT RANGE: DOORS/WINDOWS/WINDOWS WALL/CURTAIN WALL/HANDRAILS..**

**IMPORT NOTICE:** In case of hackers or cheaters, pls make sure our payee are only followings 3:

Payee 1: Shanghai Superhouse Building Material Co.,Ltd

Payee 2: Superhouse (Jiangsu) Windows System LLC

Payee 3: Shanghai Superwu Therm Windows,LLC

